



# Congratulations on your new Asetek Racing™ Forte™ Formula Pro Steering Wheel

This manual is written for the end-user of the Asetek Racing™ Forte™ Formula Pro Steering Wheel and contains all the information required to correctly and safely install and use your new product.

- WARNING:**
  - Choking Hazard – Small parts. Not for children under 3 years.
  - If the Forte™ Formula Pro Steering Wheel becomes damaged in any way, stop using it immediately and contact Asetek support or the reseller from whom you bought it.
  - Use of the Forte™ Formula Pro Steering Wheel is allowed only by an instructed person who understands and follows the above safety instructions.
  - Operating environment:
    - 0°C – 40°C room temperature, non-condensing humidity
    - Indoor use only
- Warranty**

Asetek SimSports® offers 24 Month warranty on all products.

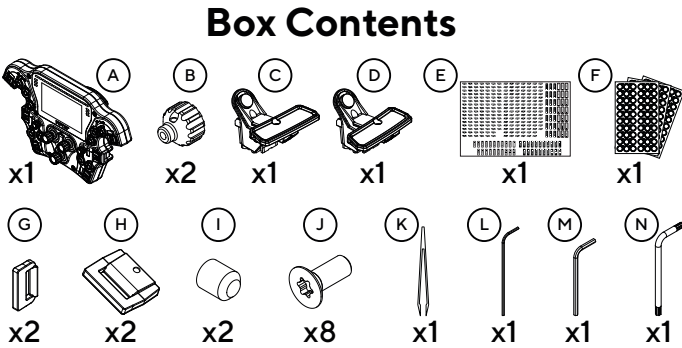

## Wheel Overview



## Quick Release Adapter

To attach the wheel to an Asetek wheelbase, simply hold the wheel with both hands and slide it on the wheelbase's quick release from the top.

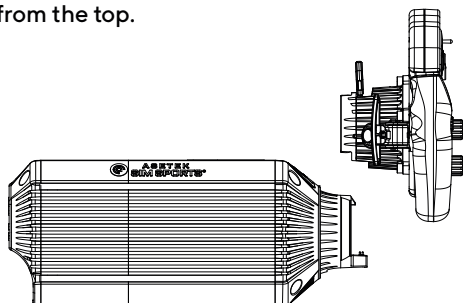

To detach the wheel from an Asetek wheelbase, press the paddle on the wheel's Quick Release adapter and pull the wheel up.

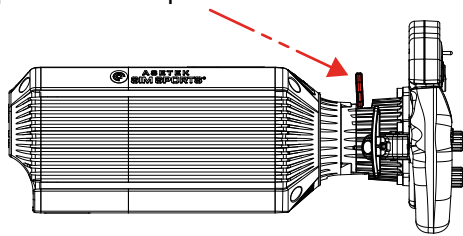

## Change Kinky Switches

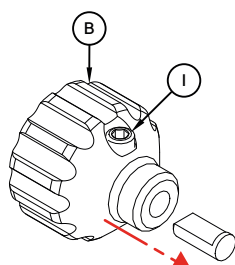
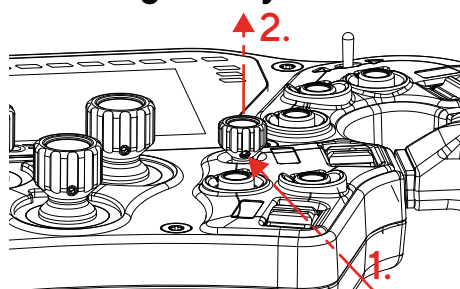

### NOTICE

Line up the screw head with the flat side of the switch rod for a secure fit.

## Mounting Handles

### NOTICE

Handles are sold separately. Instructions apply to all handles.

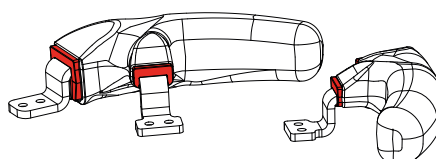
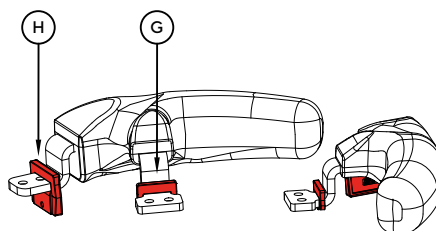

### NOTICE

To protect your wheel, place the front on a soft surface while working.

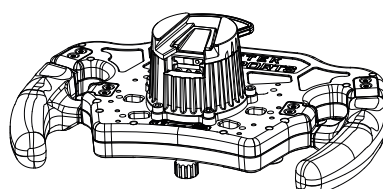
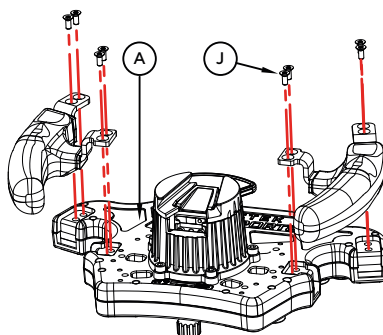

## Mounting Shifter Paddles

Loosen the highlighted screw. Be careful not to unscrew it fully.

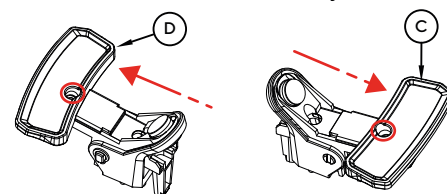

### NOTICE

To protect your wheel, place the front on a soft surface while working.

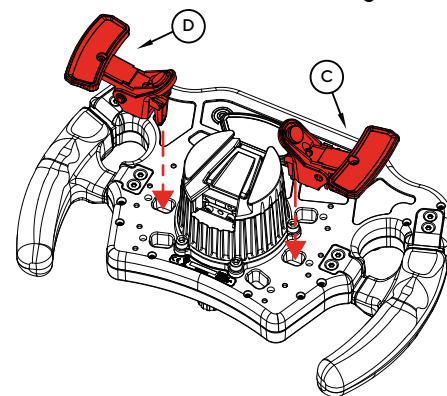

To prevent scratches place a finger on the magnet while tightening the screw.

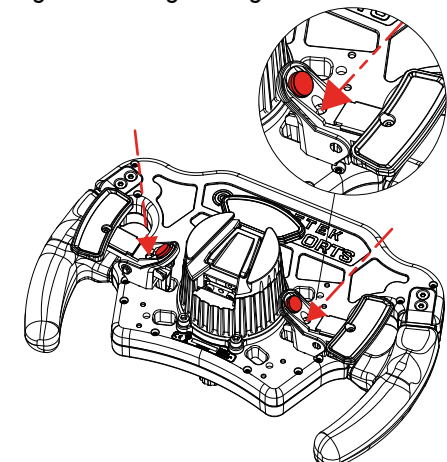

Adjust the shifter paddles to your preferred length, then securely tighten the screws.

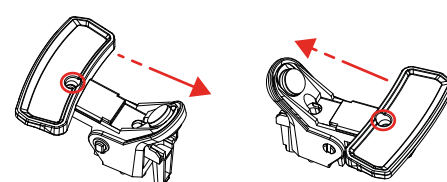

## Need Assistance?

### Support



### Knowledge base



Manual Version 1.0

### Videos



### De-commissioning & Sustainability

At Asetek we are fiercely committed to making the world a sustainable place.  
[www.asetek.com/company/sustainability](http://www.asetek.com/company/sustainability)

### Packaging

All packaging is made of paper and cardboard. All our cardboard and paper products are labeled with the FSC mark, ensuring maximum reusability and that the forests are sustainably forested. Furthermore, we regularly check our vendors to make sure they are upholding their commitments.

About FSC: [www.fsc.org/en/fsc-labels](http://www.fsc.org/en/fsc-labels)

If you need to dispose of your packaging, please use the appropriate paper waste stream in your country, to dispose of the packaging. Naturally, we hope you want to keep it around - we are quite proud of it.

### Product

If you feel uncertain about how to recycle any Asetek SimSports® or Asetek Racing™ product, we suggest getting in touch with our dedicated customer support team, who will happily help you.

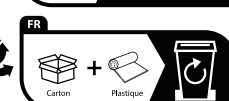

Points de collecte sur [www.quefairedemesdechets.fr](http://www.quefairedemesdechets.fr)  
Privilegies la réparation ou le don de votre appareil !